

INSTRUCTIONS FOR USE

DESCRIPTION

The FastBreak™ Breakaway Connector is a two-piece coupling with a patient side connecting to the hub of the drainage catheter, and a second side connecting to the drainage bag during placement. In use, the two (2) connected components allow fluids to pass freely. Upon application of variable strength against the catheter tubing, the coupling will detach. The FastBreak connector lessens the chance of the drainage catheter being inadvertently detached. The FastBreak connector should not be used with biliary catheters.

FASTBREAK INSTALLATION

1. Connect the male luer end of the FastBreak connector to the open end of the all-purpose drainage catheter and twist in a clockwise direction. (See Step 2)
2. Connect the open female end of the FastBreak connector to the male luer end of the external fluid reservoir and twist in a clockwise direction. (See Step 3)
3. Connect the FastBreak male to female connectors together until you hear a “click” noise. (See Steps 4 and 5)

INDICATIONS FOR USE







The FastBreak connector is intended to serve as a conduit between a general drainage catheter and an external fluid reservoir.

PRECAUTIONS

- Follow instructions for use and institutional guidelines for disposal.
- Do not store at extreme conditions.
- Do not use in biliary application

REUSE PRECAUTION STATEMENT

For single patient use only. Do not reuse, reprocess or resterilize. Reuse, reprocessing or resterilization may compromise the structural integrity of the device and/or lead to device failure which, in turn, may result in patient injury, illness or death. Reuse, reprocessing or resterilization may also create a risk of contamination of the device and/or cause patient infection or cross-infection, including, but not limited to, the transmission of infectious disease(s) from one patient to another. Contamination of the device may lead to injury, illness or death of the patient.

	Do not use if package is damaged				
	Do not re-use. Do not resterilize				
	Consult instructions for use				
	Not for individual sale.				
Rx ONLY	Caution: Federal (USA) law restricts this device to sale by or on the order of a physician.				
	Orange (light)		Green (medium)		Yellow (strong)

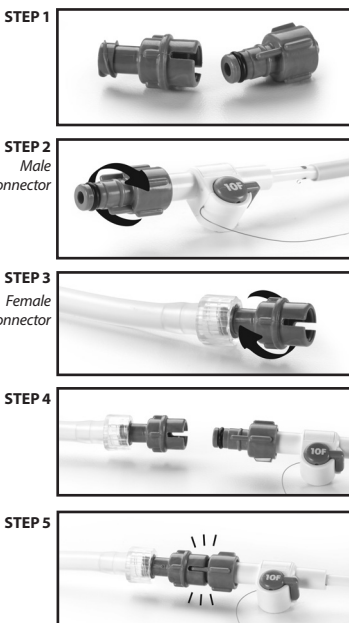

CE 0086

 **MERITMEDICAL®**

www.merit.com



Manufacturer:
Merit Medical Systems, Inc.
1600 West Merit Parkway, South Jordan, Utah 84095 U.S.A.
1-801-253-1600
U.S.A Customer Service 1-800-356-3748

EC REP

Authorized Representative:
Merit Medical Ireland Ltd, Parkmore Business Park West, Galway, Ireland
EC Customer Service +31 43 3588222